

“Advancement of fire and  
disaster management technology”

# 2019 FIRE TECH KOREA

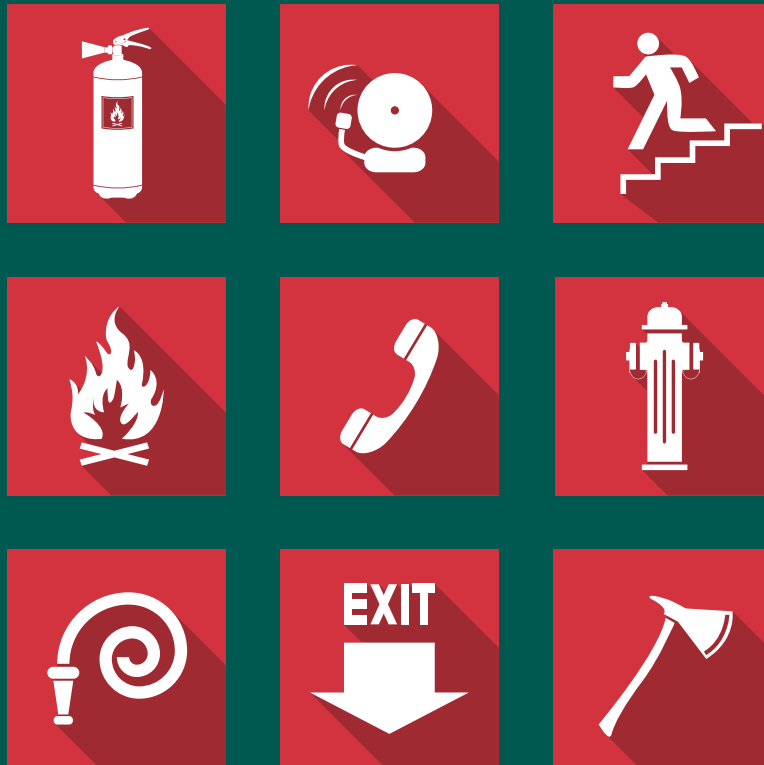

**Date : Aug. 21(wed) ~ 23(Fri), 2019**

**Venue : aT Center (Seoul, Korea)**

**Organizer Info** | TEL : 82-31-388-6311  
FAX : 82-31-388-6310  
E-mail : fp@miceforum.co.kr

# General Information



**Title** FIRE TECH KOREA 2019

---

**Date** Aug 21st(Wed) ~ 23rd(Fri), 2019  
The set-up date : Aug 19th~20th  
The removal date : Aug 23rd

---

**Venue** aT Center (Seoul, Republic of Korea)

---

**Organizer** Korean Society of Fire Protection Professional Engineers, MICE FORUM

---

**Supporting Agency** Korea Land & Housing Corporation, Seoul Housing & Communities Corporation, Korea Fire Institute, The Korean Federation of Fire Association, Korean Institute of Fire Science & Engineering, Korea Fire Facility Association, Korea Fire Protection System Management Association, The Korea Society of Disaster Information, Korea Fire Industry Cooperative, Fire Guarantee, Council for Fire Protection Engineering Professor, Korea Seismic Safety Institute

---

**Main Purpose**

1. Developing domestic and foreign fire and disaster management industrial technology and expanding trade between relevant enterprises
2. Promoting sales of participating enterprises by attracting interested buyer
3. Seeking cooperation opportunity between fire and disaster management enterprises and understanding market trend and new product and technology
4. Spreading safety culture in Korea against fire and disaster

---

**Organizer Info** TEL : 82-31-388-6311  
FAX : 82-31-388-6310  
SITE : [www.fpexpo.co.kr](http://www.fpexpo.co.kr)  
E-mail : [fp@miceforum.co.kr](mailto:fp@miceforum.co.kr)

Fire prevention & safety exhibition

# Exhibit Profile

## [1] Event

1. Industry exhibition for the material of firefighting facilities and earthquakes (Concurrent event)
2. Disaster management system development forum for technology of fire and disaster management industry
3. Job training for fire engineers and business networking
4. Technical seminar for firefighting seismic design at home and abroad

※ It can be changed according to the organizer.

## [2] Exhibition Item

- |   |  |                           |
|---|--|---------------------------|
| ■ Fire safety information system          | ■ Information delivery system                | ■ Smoke control system    |
| ■ Firefighting and prevention equipment   | ■ Evacuation guiding                         | ■ Personal safety devices |
| ■ First aid supplies                      | ■ Earthquake-proof                           | ■ Fire alarm system       |
| ■ Seismic design                          | ■ Seismic isolation products                 | ■ Simulation              |
| ■ Instrumentation and control engineering | ■ Safety quality warranty                    | ■ Disaster safety kit     |
| ■ Detection and sensing technology        | ■ Fire and disaster protection products      | ■ Firefighting machine    |
| ■ Electrical fire protection equipment    | ■ Automatic redetection equipment and others |                           |

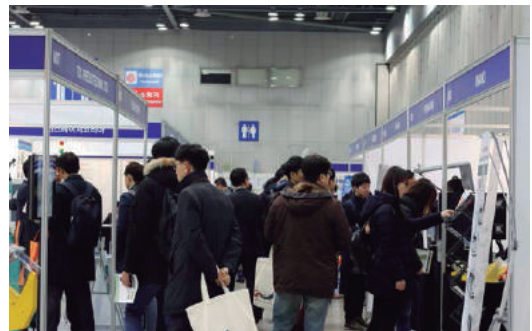

# Intro of Booth Construction

## Customized Booth Information

- ※ This is when the participating companies are only provided with the exhibition floor space by the organizer so that they can install display installations, work on electricity and lighting, either individually or by requesting a contractor. The participating company may use more than 2 Booths (18m<sup>2</sup>).  
(The participating company must submit the installation drawings to the organizer and **atCenter** and receive prior approval when working with a contractor)
  - For a more efficient exhibition organization regarding the booth location and display size, the organizers have limited the top height of the installations.
  - For safety and efficient operation management, the contractors for the installation must be selected from the **atCenter** appointed company.
- ※ If the participating company's installation exceeds the height specified by the organizations or violates the regulations and falsely reports the height, then the exhibition booth will be dismantled and the company will be not allowed to participate the following year.
- ※ The construction design or booth installation will not be approved if the stage for the event is too close to the passage way.

## Standard Booth Information

- ※ This is the standard installation for the participating companies to showcase their exhibit. The booth fee is included in the entry fee and will be uniformly provided/installed by the organizer.
- ※ Information on Provisions Provided by the Organizer
  - Booth walls, Signboard (Korean & English), Pytex flooring, 1 information desk, 1 chair, 1 electric socket (220V), 3 spotlights (100W)
- ※ Details
  - Only one information desk, chair, and electric socket is supplied to participating companies regardless of the size of the booth
  - The principle is for the signboards to be in a unified Korean typeface, and only uppercase letters are allowed when written in English
  - Use furniture leasing company (appoint service contractor) for furniture within the booth such as counseling tables, shelves, etc.

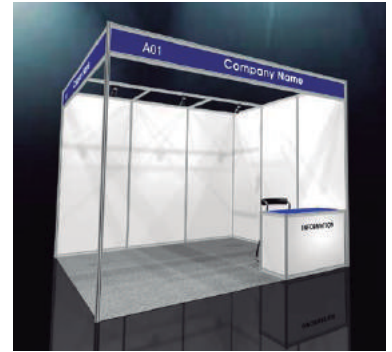

## Special Booth Information

- ※ A low-costing booth package between the size of a standard booth and an independence booth with the effect of an independence booth. (The floor size of booth is 3m\*3m)



### 2 booths type

#	Contents	Q'ty	Remark
<b>Booth Size</b>			
④	6M X 3M X (h)3.5M		
<b>Power &amp; lighting</b>			
1	Socket	2EA	
⑥	SPOTLIGHT(100W)	13EA	
<b>Fascia</b>			
①	Fascia	5EA	
<b>Pairontex the floor</b>			
②	Pairontex	1SET	
<b>Furniture &amp; equipment</b>			
③	Information desk	1SET	Include one chair
④	Meeting table SET	1SET	Include four chair
⑤	Show case	2EA	
⑥	Display table	1EA	

# Application Guidelines

## ○ The deadline for application

May 30th, 2019 (first-come, first-served basis)

## ○ Application procedure

After fill out the application, please submit it to us by  
E-mail (fp@miceforum.co.kr) or FAX (+82-31-388-6310)

## ○ Participation fees

(VAT excluded)

Booth type	Early-bird registration (Dec 21, 2018)	General registration (May 30, 2019)
Standard booth	\$2,300	\$2,700
Customized booth	\$2,000	\$2,400
Special booth	\$3,200	\$3,600

\* Participant can apply special booth when more than two booths

## ○ Payment

Type	Price	Dead line
Deposit	50% of total booth price	Within 7days after Application
Balance	50% of total booth price	Within 14days after Application

※ A remittance account  
Bank Name : Shinhan Bank  
Account No. : 110-338-929098  
Beneficiary : MICE forum  
SWIFT CODE : SHBKRRSE  
Bank Address : 120 Taepyeongro2-ga, Jung-gu, Seoul, Korea

## ○ Participation Process

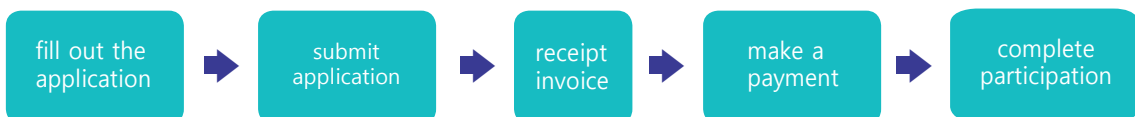

# Location

o **aT Center** Address : 27, Gangnam-daero, Seocho 06774, Korea

## o Directions



## ■ Subway

Get on the subway, Transfer to New Bun-Dang Line(Brown Color), Get off the Yangjae Park for Citizen Station -> Exit No.4

## Organizer info

TEL : 82-31-388-6311 FAX : 82-31-388-6310 E-mail : fp@miceforum.co.kr WEBSITE : www.fpexpo.co.kr